

Plan

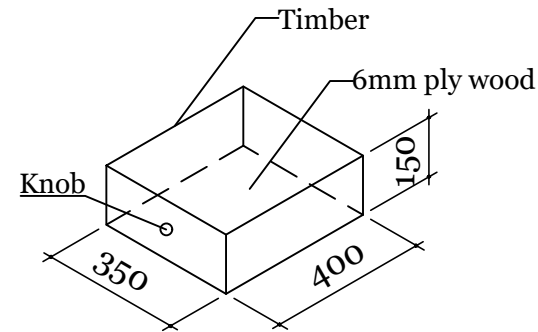

Drawer

Notes:

1. All the furniture parts shall be made of well seasoned timber.
2. All parts of the furniture shall be 20mm thick timber.
3. Proper joints with high quality glues shall be used in joineries.
4. All parts of the furniture shall be finished with water proof lacquer coating.
5. All sharp edges to be rounded off.
6. Drawer bottom to be made of 6mm thick ply wood.

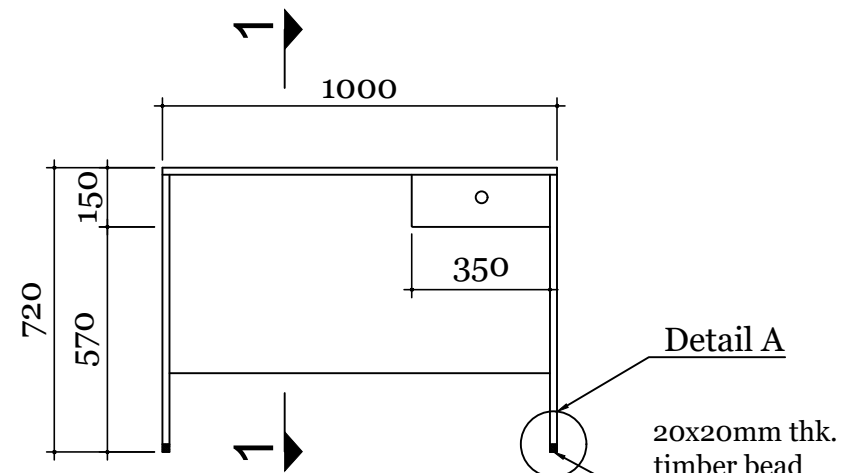

Front Elevation

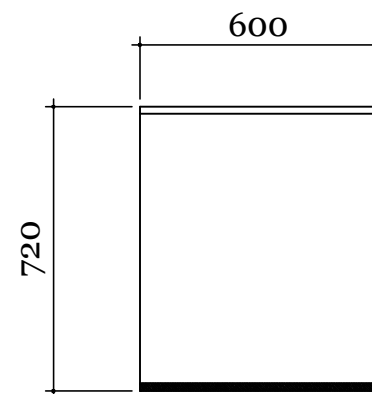

Side Elevation

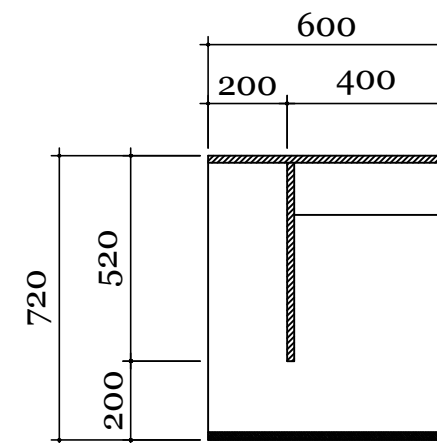

Section 1-1

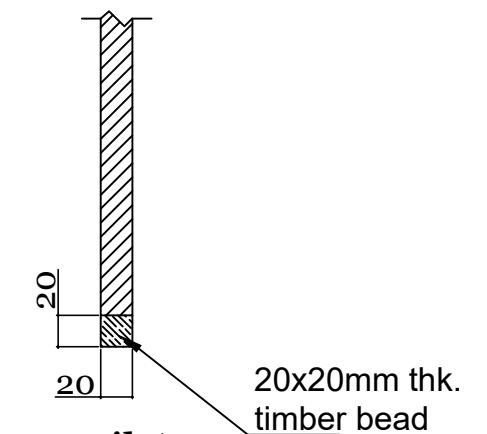

Detail A

Scale-1:2

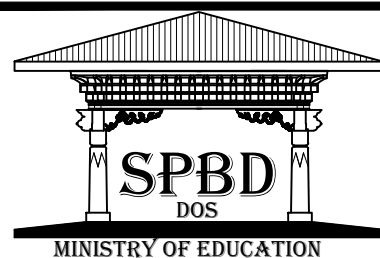

2019

TEACHER TABLE (W)

TITLE: PLAN,ELEVATION & SECTION

HON'BLE SECRETARY
MOE

CHIEF ENGINEER

ARCHITECT

ENGINEER

DIRECTOR, DOS

DRAWN BY

SCALE 1:20,1:2

DATE 12/12/2011

NOTES:

- ALL DIMENSIONS ARE IN MM UNLESS SPECIFIED OTHERWISE.
- ALL DIMENSIONS MEASURE UNFINISHED SURFACES UNLESS SPECIFIED OTHERWISE.
- ALL DIMENSIONS ARE TO BE READ AND NOT SCALED OFF.
- ANY DISCREPANCIES IN DRAWINGS SHOULD IMMEDIATELY BE BROUGHT TO THE NOTICE OF THE SPBD DESIGN TEAM

REVISION

Mani Pradhan

DATE

Sept. 2019

DRAWING CODE:

FURN-TA

DRAWING NO:

TA-10